

SIGMA BIKE COMPUTER  
BC 1706 HR

BIKE COMPUTER  
TOPLINE

  
**SIGMA**<sup>®</sup>  
GERMANY

WWW.SIGMASPORT.COM



DTS



WWW.SIGMASPORT.COM

BC 1706 HR **DTS**

**SIGMA EUROPA:**  
SIGMA Elektro GmbH  
Dr.-Julius-Leber-Straße 15  
D-67433 Neustadt a.d.V.  
Tel. +49-(0)6321-9120-118  
Fax +49-(0)6321-9120-34

**SIGMA SPORT USA**  
North America  
1087 Kingsland Drive  
Batavia, IL 60510, USA  
Tel. +1-630-761-1106  
Fax +1-630-761-1107

**SIGMA ASIA:**  
Asia, Australia, South America  
7F-1, No. 193, Ta-Tun 6th Street,  
Taichung City, Taiwan  
Tel. +886-4-2475 3577  
Fax +886-4-2475 3563



DEUTSCH  
ENGLISH  
FRANÇAIS  
ITALIANO  
ESPAÑOL

NEDERLANDS  
PORTUGUÊS  
POLSKI  
MAGYAR  
ČEŠTINA



**1 Familiarization**

1.1 Introduction and packaging contents	29
1.2 Key functions/Functions table	30
1.3 Assembly	31
1.4 Pairing	35
1.5 Create settings	36
1.6 Stopwatch	46
1.7 Timer	47
1.8 Kilometer Counter	48

**2 Other functions**

2.1 Comparison Speed	48
2.2 Delete	49

**3 Technical Data**

3.1 General warnings	50
3.2 Warranty	51
3.3 Trouble Shooting	52
3.4 Battery Change	52

**Functions of the BC 1706 HR**

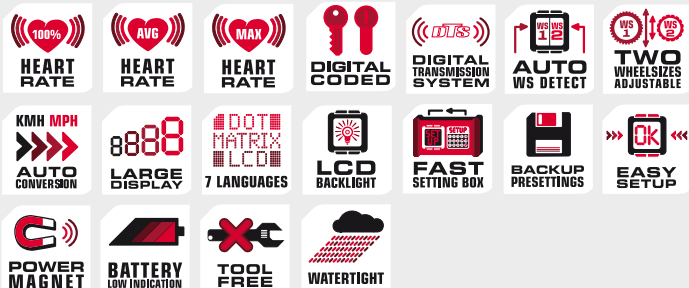

**Introduction**

Congratulations on having chosen a bicycle computer from SIGMA. Your new BC 1706 HR will provide you reliable service in riding your bike for many years to come.

The BC 1706 HR is a state-of-the-art measuring instrument. Please read instructions carefully to become familiar with the functions and usage of this bicycle computer.

SIGMA wishes you an enjoyable time using your BC 1706 HR.

Homologation under:



Bike computer BC 1706 HR



Elastic band  
Pulse monitor with transmitter



Transmitter, magnet, battery door key and mounting bracket



Fixation accessories





The key functions

**RESET**

Reset the functions listed below



**MODE 2**

Call forward the functions listed below

**SET**

Setting the various parameters

**MODE 1**

Call forward the functions listed below

The functions

**RESET**

TRIP DIST  
TRIP TIME  
AVG. SPEED  
AVG. HR  
MAX. HR  
MAX. KM/H  
STOPWATCH  
TIMER +/-  
TRIP +/-



**MODE 2**

EKG PULSE  
AVG. PULSE  
MAX. PULSE  
CLOCK  
STOPWATCH  
TIMER +/-  
TRIP +/-  
ODO BIKE 1/2\*  
TOTAL ODO\*  
TIME BIKE 1/2\*  
TOTAL TIME\*

**MODE 1**

TRIP DIST  
TRIP TIME  
AVG. SPEED  
MAX. KM/H

**SET**

LANGUAGE  
WS BIKE 1/2  
SHOW PULSE YES/NO  
TRIP +/-  
TIMER +/-  
etc.

Pressing RESET and SET buttons on the same time will switch on/off the display backlight.

\*not whilst moving

Installation of Mounting Bracket

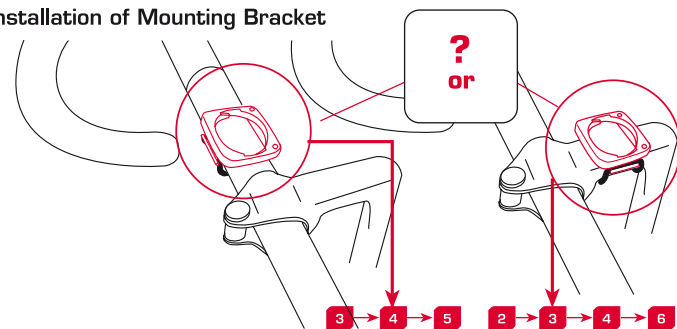

1

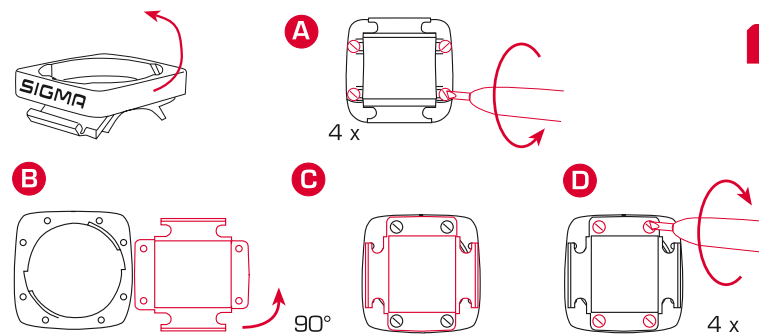

2

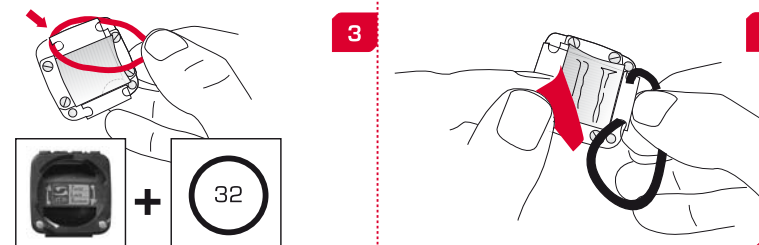

4

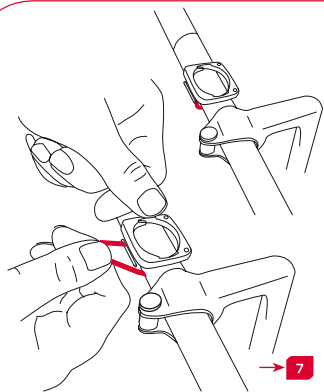

5

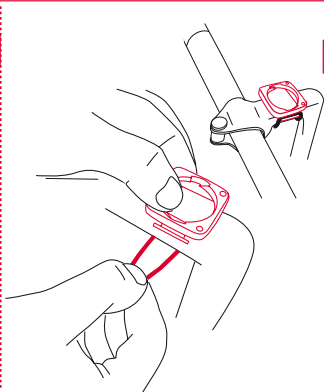

6

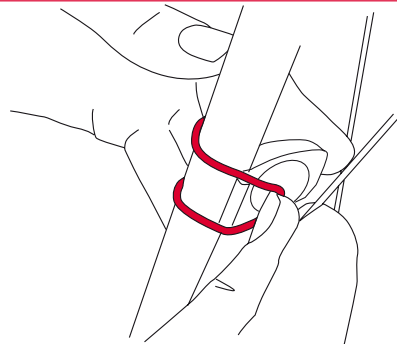

9

Installation of Magnet

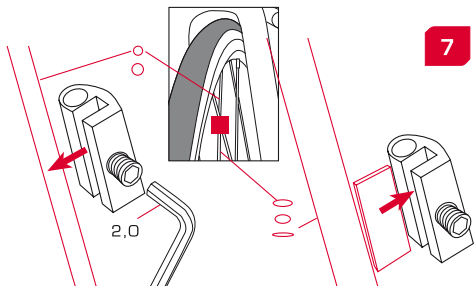

7

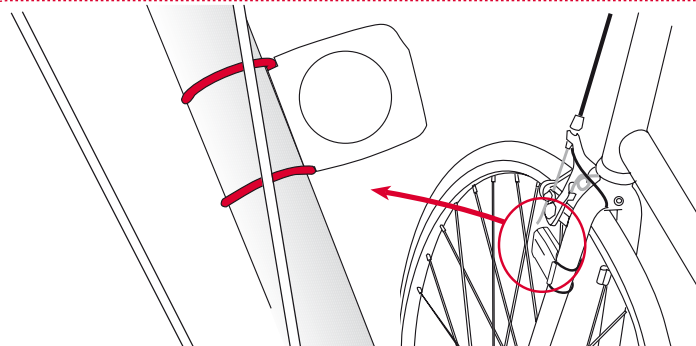

10

Installation of the transmitter

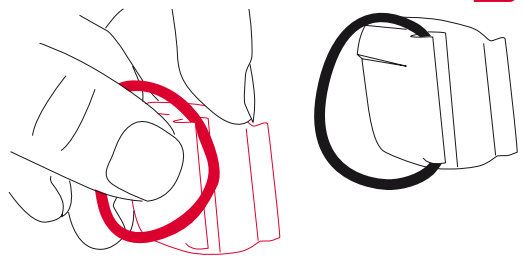
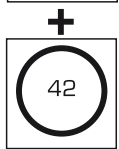

8

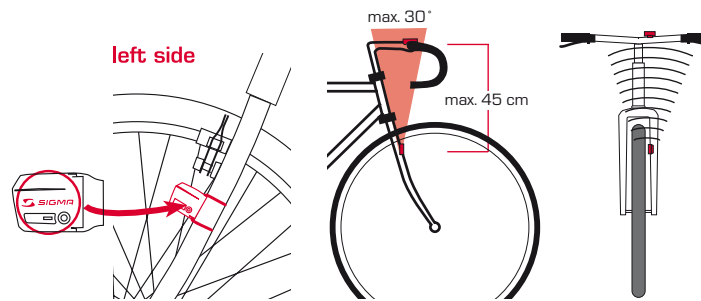

11

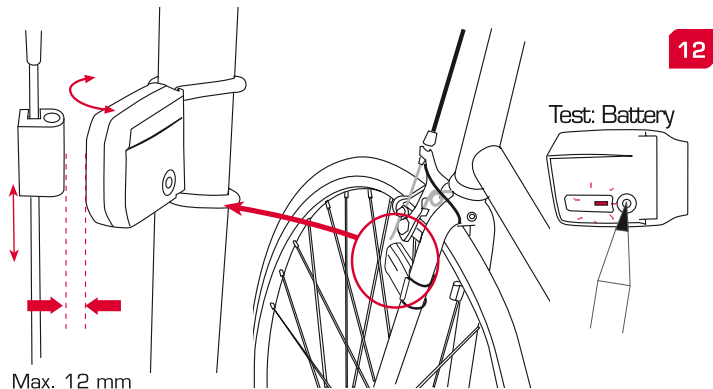

Max. 12 mm

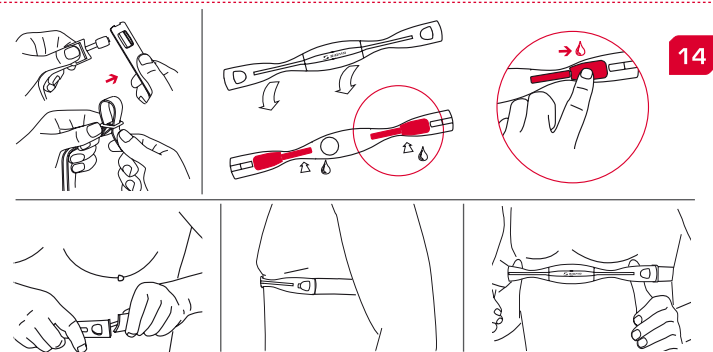
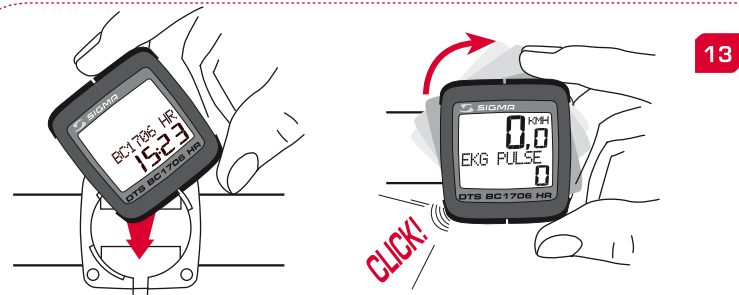

CONNECTION

- Installation of the BC 1706 HR into the mounting bracket. Zero on speed and pulse display is blinking.
- If needed, press MODE 2 until ECG PULSE is displaying.

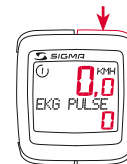

- There are 2 possibilities to pair speed and heart rate:

1. Riding, after 20 seconds (max. 5 min.) the receiver has matched with both transmitters, data will be displayed.

~20 sec



2. Turn front wheel until KMH/MPH display has stopped blinking (A).

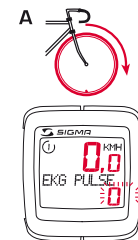

The chest belt transmit some signals (B) ECG PULSE stops to blinking, values are shown.





- After 5 min. of no transmission, BC 1706 HR changes to sleep mode (Time and Model name shown in the display). Press any button to re-activate the Computer a short Pairing will find the transmitter.
- Removing the BC 1706 HR from the mounting will cut off the connection.



- If TOO MANY SIGNALS are shown: Extend the distance of all transmitters and press any button to continue. Pairing starts again.



**DISPLAY CHANGE**

- Press MODE1 button until the desired function is displayed (TRIP DIST, TRIP TIME, AVG. SPEED, MAX. SPEED).



- Press MODE 2 button until the desired function is displayed (ECG PULSE, AVG. PULSE, MAX. PULSE, CLOCK, STOPWATCH, TIMER, TRIP UP/DOWN, ODO BIKE 1/2\*, TOTAL ODO\*, TIME BIKE 1/2\*, TOTAL TIME\*)

\* not whilst moving



↓ RESET

**DISPLAY ILLUMINATION**

- The lighting function is switched on/off when you press the SET and RESET button at the same time.

↑ SET

- Display quickly shows LIGHT ON/LIGHT OFF.



- By pressing any button display will be illuminated, with the next pressure you can switch to the next function.  
**Protect the battery by avoiding unnecessary illumination!**



**BASIC SETTINGS**

- Press SET for 3 sec to make the following basic settings:



↑ SET > 3 sec

- Language, change between kmh/mph, wheel size 1/2, time, show pulse, km-bike 1/2, time-bike 1/2 and display contrast. After changing the battery only the time and display contrast have to be entered.



**1. ASSEMBLY 2nd WHEEL**

Switching between WHEEL 1 and WHEEL 2 is automatic.



bike 1



grey



Optional bike 2  
Art.-Code:  
00405



red



- You have to take the (optional) transmitter bike 2 (red button).
- It is no longer possible to change by making an entry.
- There is only one heart rate transmitter.



↑ SET

## 2. LANGUAGE ENTRY

- Press MODE1 until LANGUAGE is displayed.
- Press the SET button briefly.



MODE1 ↑

- The display flashes. Set the desired language using the MODE1 button and.



↑ SET

- Confirm by pressing SET.



- SET OK in Display confirm the modification.



## 3. KMH / MPH ENTRY

- Press MODE1 to change between KMH/MPH entry.
- Press SET briefly.



↑ SET

- KMH or MPH is displayed and flashes.
- Select MPH or KMH using MODE1.

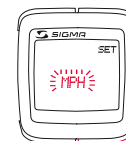

MODE1 ↑

→ MPH KMH

- Confirm by pressing the SET button.



↑ SET

- SET OK in Display confirm the modification.





↑ SET

#### 4. WHEEL SIZE BIKE 1 ENTRY

- Press MODE1 to change to BIKE 1.
- Press SET briefly.

↓ RESET ↓ M2



- Wheel size is displayed and the first digits blink.
- Select values by pressing MODE2 (+) or RESET (-).



MODE1 ↑

- Press MODE 1 button to change to the next digit, enter the values as shown above.

bike 1



grey

- Bike 1 is always the bike with the transmitter Bike 1 (grey plate).

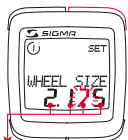

Wheel Size Chart

- Determine the correct value for your wheel size from Table C "Wheel Size Chart" (refer to next page). Enter this value.

- Enter the value with RESET/MODE 2 button.
- Alternatively: calculate/determine WS (Tab. A or Tab. B).

↓ RESET ↓ M2

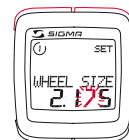

- After the last digit, confirm by pressing SET.

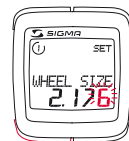

↑ SET

#### WHEEL SIZE CHART

A

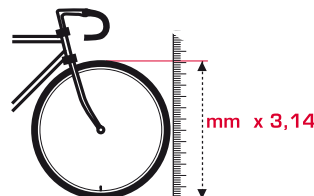

km/h:  
WS = mm x 3,14  
mph:  
WS = mm x 3,14

B

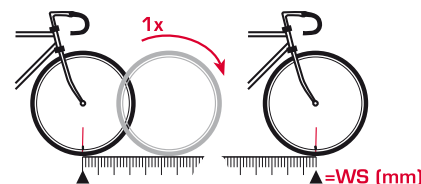

km/h:  
WS = mm  
mph:  
WS = mm





**C**

**ETRTO**

16 x 1.75 x 2

47-305	16x1.75x2	1272
47-406	20x1.75x2	1590
37-540	24x1 3/8 A	1948
47-507	24x1.75x2	1907
23-571	26x1	1973
40-559	26x1.5	2026
44-559	26x1.6	2051
47-559	26x1.75x2	2070
50-559	26x1.9	2089
54-559	26x2.00	2114
57-559	26x2.125	2133
37-590	26x1 3/8	2105
37-584	26x1 3/8x1 1/2	2086
20-571	26x3/4	1954

kmh  
mph

**ETRTO**

16 x 1.75 x 2

32-630	27x1 1/4	2199
28-630	27x1 1/4 Fifty	2174
40-622	28x1.5	2224
47-622	28x1.75	2268
40-635	28x1 1/2	2265
37-622	28x1 3/8x1 5/8	2205
18-622	700x18C	2102
20-622	700x20C	2114
23-622	700x23C	2133
25-622	700x25C	2146
28-622	700x28C	2149
32-622	700x32C	2174
37-622	700x35C	2205
40-622	700x40C	2224

kmh  
mph



- Bike 2 is always the bike with the speed transmitters labeled bike 2 (optional).

optional Bike 2  
Art.-Code:  
00405



Red



Bike 1

**6. TIME ENTRY**

(kmh = 24 h / mph = 12 h)

- Press MODE1 until CLOCK is displayed.
- Press the SET button briefly.



↑ SET

- The entry flashes.
- Set the hours with the RESET/MODE2 button.

RESET ↓ ↓ M2



- Change to the minute entry by pressing MODE1.
- Set the minutes with the RESET/MODE2 button.



MODE1 ↑

- SET OK in Display confirm the modification.



**5. WHEEL SIZE BIKE 2**

- Press MODE1 to change to BIKE 2.
- Press SET briefly.



↑ SET

- First digit flashes.
- Entry as for WHEEL 1: Select values by pressing RESET/MODE2, move to the next digit by pressing MODE1 etc.





↑ SET

- Confirm by pressing the SET button.



↑ SET

## 7. HEART RATE DISPLAY

- Press MODE 1 button until SHOW PULSE is displayed.
- Press SET briefly.

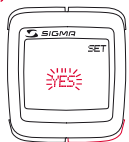

MODE1 ↑

- Entry shows the current setting.
- Select YES or NO by pressing MODE1, confirm by pressing SET.
- YES, if you wear the chest belt transmitter.

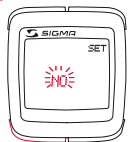

↑ SET

- Selecting NO, the ECG PULSE, AVG PULSE and MAX PULSE functions will not be displayed and there will be no pairing.
- Confirm by pressing the SET button.



- SET OK in Display confirm the modification.

## TOTAL DATA ENTRY

### 8. KM-BIKE 1/2

### 9. TIME-BIKE 1/2

- You can transfer the total Km, e.g. when purchasing this device, from another bike computer here.
- Press SET briefly.



↑ SET

- The first digit is flashing.



MODE 1 ↑

- Proceed like for the wheel size:  
Select value by pressing RESET/MODE2, move to the next digit by pressing MODE1 etc.

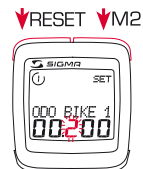

↓ RESET ↓ M2

- Press MODE 1 button for moving to the next digit.



MODE 1 ↑

- After entry of the last digit confirm by pressing SET.



↑ SET



↑ SET

### 10. CONTRAST

- Press MODE1 until CONTRAST is displayed.
- Press SET briefly.

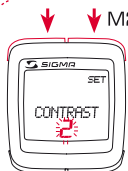

↓ ↓ M2

- The entry flashes.
- Set the value by pressing the RESET/MODE2 button (1=weak 3=strong).



↑ SET

- Confirm by pressing the SET button.
- To leave the setting menu please hold the SET-button for 3 seconds.

### 1.6 SET STOPWATCH



↑ SET

- Press MODE 2 until STOPWATCH is displayed.
- Press SET to start.



↑ SET

- Stop and re-start by pressing the SET button.

- Hold down RESET > 3 sec to reset the display to zero.

↓ RESET > 3 sec

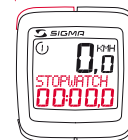

### 1.7 SET TIMER (+/-)

- Press MODE 2 until TIMER +/- is displayed.
- Hold down the SET button.



↑ 2 sec

- Display flashes.
- Press MODE1 to count upwards (+) or downwards (-).
- Confirm by pressing the SET button.



MODE1 ↑

- Enter the starting time for TIMER +/- by pressing RESET/MODE2.

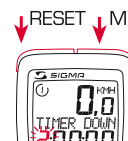

↓ RESET ↓ M2

- Press MODE1 to jump to the next digit. Confirm by pressing the SET button.



MODE1 ↑

## 1.8 SET KM COUNTER (+/-)



## 2.1 COMPARE SPEED

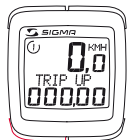

↑ 2 sec

- Press MODE 2 until TRIP UP/DOWN is displayed.
- Hold down the SET button.



MODE1↑

- Display flashes.
- Press MODE1 to count upwards (+) or downwards (-).

RESET↓ M2



- Confirm by pressing the SET button.
- Enter the starting time for TIMER +/- by pressing RESET/MODE2.



MODE1↑

- Press MODE1 to jump to the next digit.
- Set the value by pressing the RESET/MODE2 button.
- Confirm by pressing the SET button.

## 2.1 COMPARE SPEED



### Speed/Average speed

- If the speed is nearly the same ■ is displayed.

- If lower speed ↓ will be displayed.



- If higher speed ↑ will be displayed.
- It is displayed for all functions except in the basic settings.



## 2.2 DELETE

### RESET DISPLAY

- Press MODE1/2 until the desired function is displayed.
- Hold down the RESET button.

↓ > 2 sec



- Display flashes.



- After 2 sec **only** the displayed function is reset to 0.





↓ &gt; 3,5 sec



- Press RESET for longer than 4 sec to reset the displays for AVG. PULSE, MAX. PULSE, TRIP DIST., TRIP TIME, AVG.SPEED, MAX. SPEED to zero.

### 3. TECHNICAL DATA

	Default	Max	Min	Units
Speed	0,0	199,5*		kmh/mph
TRIP DIST	0,00	9.999,9		km/mi
TRIP TIME	0:00:00	999:59		h:mm:ss hh:mm hhh:mm
EKG PULSE	0	240	40	bpm
STOPWATCH	00:00,0	999:59		mm:ss,1/10 h:mm:ss hhh:mm
TIMER +/-	0:00:00	9:59:59	-59:59	- mm:ss h:mm:ss
TRIP +/-	0,00	999,99	-99,99	km/mi
TOTAL ODO 1/2	0	99.999		km/mi
TOTAL TIME 1/2	0:00	9.999		h:mm hh:mm hhh:mm h.hhh
WHEEL SIZE 1/2	2.155	3.999	1.000	mm

\*Depends on the presettled wheel size

### 3.1 GENERAL WARNINGS



Battery:  
1 lithium button cell 2032, 3V.  
In case Computer battery is weak, battery symbol and "LOW" will be displayed.

Computer: 1 x CR 2032, 3V  
Speed transmitter: 1 x CR 2032, 3V  
Chest belt: 1 x CR 2032, 3V



#### MEMORY:

The data will be recorded by:

- Quit the setting menu
- Going into sleep mode

### 3.2 WARRANTY

We are liable to our contracting partners for defects as defined by law. Batteries are excluded from the guarantee.

Batteries can be returned after use.



