

## TECHNICAL DATA / ASSEMBLY REQUIREMENTS

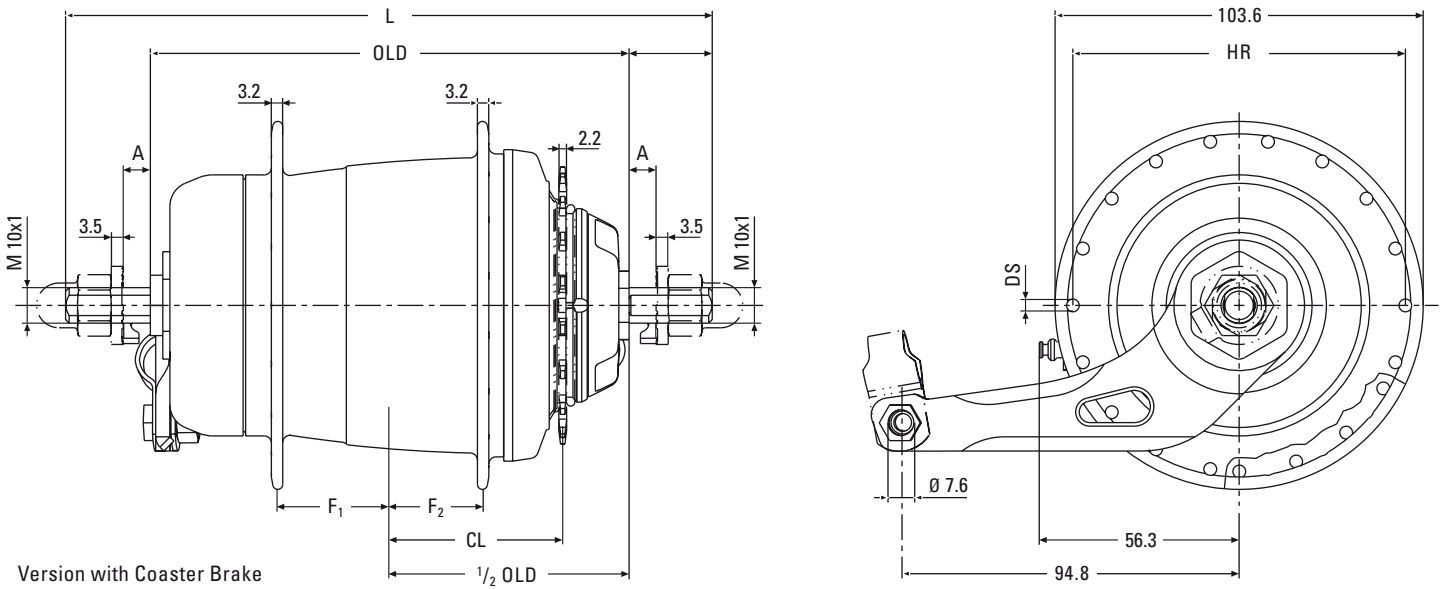

Version with Coaster Brake

		i-MOTION 9 with Coaster Brake	i-MOTION 9 for i-BRAKE	i-MOTION 9 for Disc Brake	i-MOTION 9 without Brake
H U B S	Type	—	—	—	—
	Speeds	9	—	—	—
	Brake	With Coaster Brake	i-BRAKE compatible	Disc Brake compatible	None
	Over Locknut Dim., OLD	135 mm	—	—	—
	Length, L	182 mm	—	—	—
	Ends Diameter	M 10x1	—	—	—
	Dropout Width Dim., A	min. 4 mm / max. 10 mm	—	—	—
	Holes	36 and 32	—	—	—
	Hole Diameter, DS	2.6 mm	—	—	—
	Hole Ref. Ø, HR	93.6 mm	—	—	—
Flange Dist. to 1/2 OLD	F <sub>1</sub> = 26.5 mm / F <sub>2</sub> = 31.5 mm	—	—	—	
Gear Hub Ratio	Totally	340 %	← Gear steps	←	←
	Speed 1	0.542	↓	←	←
	Speed 2	0.621	14 %	←	←
	Speed 3	0.727	17 %	←	←
	Speed 4	0.853	17 %	←	←
	Speed 5	1.000	17 %	←	←
	Speed 6	1.172	17 %	←	←
	Speed 7	1.375	17 %	←	←
	Speed 8	1.611	17 %	←	←
	Speed 9	1.844	14 %	←	←
Chain	Line, CL	48.9 mm	—	—	—
	Ratio	1.73 – 1.90	—	—	—
	Dimension	1/2" x 1/8" and 1/2" x 3/32"	—	—	—
Compatibility	Sprocket	18 / 19 / 20 / 21 / 22 Teeth	—	—	—
	Shifter	i-MOTION 9 IBS SL und i-MOTION 9 SL	—	—	—
	Hand Brake Lever	—	—	—	—
	Tandem	No	—	—	—
Finish	Weight	2400 g	—	—	—
	Hub Shell Material	Aluminum	—	—	—
	Finish	Satin matt „Lux“ anodized	—	—	—

AVAILABLE IN 2007

## TECHNICAL DATA / ASSEMBLY REQUIREMENTS

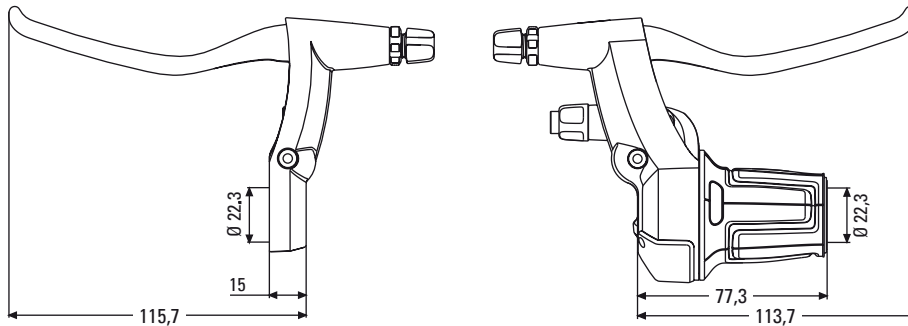

<b>S H I F T E R S</b>		<b>i-MOTION 9 IBS SL</b>	<b>i-MOTION 9 SL</b>
	<b>Version</b>	i-MOTION 9 IBS (integrated Brake Lever)	i-MOTION 9
	<b>Cable Length</b>	1400 mm / 1500 mm / 1600 mm / 1700 mm	1400 mm / 1500 mm / 1600 mm / 1700 mm
	<b>Shifter Type</b>	SRS Twist shifter with integrated Brake Lever	SRS Twist shifter
	<b>Arrangement</b>	Handlebar, right hand	Handlebar, right hand
	<b>Compat. Gear Hub</b>	i-MOTION 9	i-MOTION 9
	<b>Gear Indication</b>	Window	Window
	<b>Barrel Adjuster</b>	Indexing	Indexing
	<b>Clamping Diameter</b>	22.3 mm	22.3 mm
	<b>Handlebar, Straight Area</b>	Minimum length = 150 mm	Minimum length = 150 mm
	<b>Cable Routing</b>	Continuous housing (preassembled)	Continuous housing (preassembled)
	<b>Compatibility</b>	Linear-Pull, i-BRAKE, Avid BB Disc	—
	<b>Leverage</b>	2.32	—
	<b>Cable Pull</b>	24 mm	—
	<b>Reach Adjust</b>	Yes	—
	<b>Barrel Adjuster</b>	Yes	—
	<b>Lever Size</b>	4 Finger	—
	<b>Material</b>	Forged Aluminum	—
<b>Weight</b>	N/A	N/A	
<b>Shifter Cable</b>	Stainless steel	Stainless steel	
<b>Housing</b>	Cast Aluminum	Cast Aluminum	
<b>Grip Cover</b>	Thermoplastic elastomer	Thermoplastic elastomer	
<b>Clamping Collar</b>	Aluminum	Aluminum	
<b>Finish</b>	Mercury silver painted	Mercury silver painted	

<b>B R A K E  L E V E R S</b>		<b>SRAM i-BRAKE BL</b>	
	<b>Version</b>	i-BRAKE 60 BL, left hand	i-BRAKE 60 BL, right hand
	<b>Arrangement</b>	Handlebar, left hand	Handlebar, right hand
	<b>Clamping Diameter</b>	22.3 mm	←
	<b>Compatibility</b>	Linear-Pull, i-BRAKE, Avid BB Disc	←
	<b>Leverage</b>	2.32	←
	<b>Cable Pull</b>	24 mm	←
	<b>Reach Adjust</b>	Yes	←
	<b>Barrel Adjuster</b>	Yes	←
	<b>Lever Size</b>	4 Finger	4 Finger
	<b>Weight</b>	N/A	N/A
	<b>Housing</b>	Cast Aluminum	←
	<b>Lever</b>	Forged Aluminum	←
	<b>Clamping Collar</b>	Aluminum	←
	<b>Finish</b>	Mercury silver painted	←

## TECHNICAL DATA / ASSEMBLY REQUIREMENTS

### CYCLE FRAME

The strength must be such that with a maximum braking torque of 250 Nm (2200 in.lbs.) on the rear wheel no residual deformation can occur on the rear structure.

### DROPOUT

Only flat and no off-set versions.  
Dropout thickness: 4 – 10 mm.  
Dropouts must be parallel.

Dropout dimensions: *see figures on the right.*

#### Standard dropout

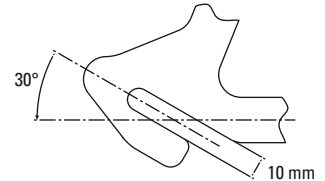
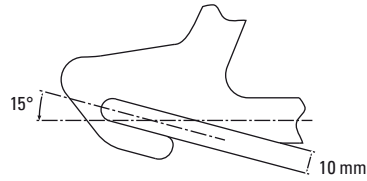

#### Vertical dropout

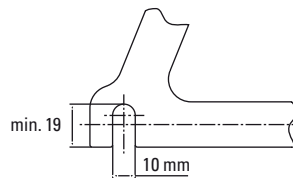



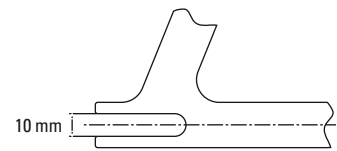



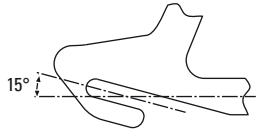
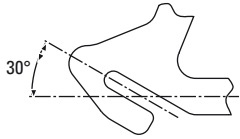
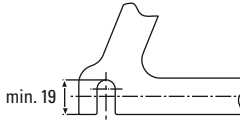
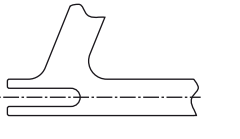

#### Reversed dropout

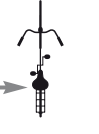
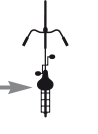

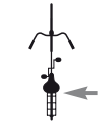
### RETAINING WASHERS

The following table shows the required combination of dropouts and retaining washers.

Type of dropout				
Required retaining washers for left hand side (non driving side)	 15L – blue dot	 30L – yellow dot	 white dot	 180 – no dot
Required retaining washers for right hand side (driving side)	 15R – red dot	 30R – green dot	 white dot	 180 – no dot

### CRANKSET

The specification of cranksets and bottom brackets need to comply with the following dimensions.

A = 48.8 mm ± 5 mm

B = 48.8 mm (rear Chainline)

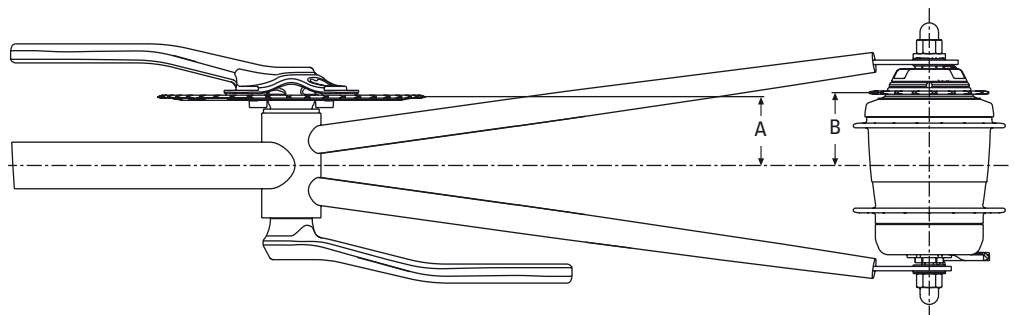

## TECHNICAL DATA / ASSEMBLY REQUIREMENTS

### HUB DIMENSIONS

The frame design needs to consider the given measures in the figures to assure best possible integration of hub and chain case.

