

# HUBS

## BENDIX COASTER BRAKE

### MODEL 76 — Short and Long Lead Models

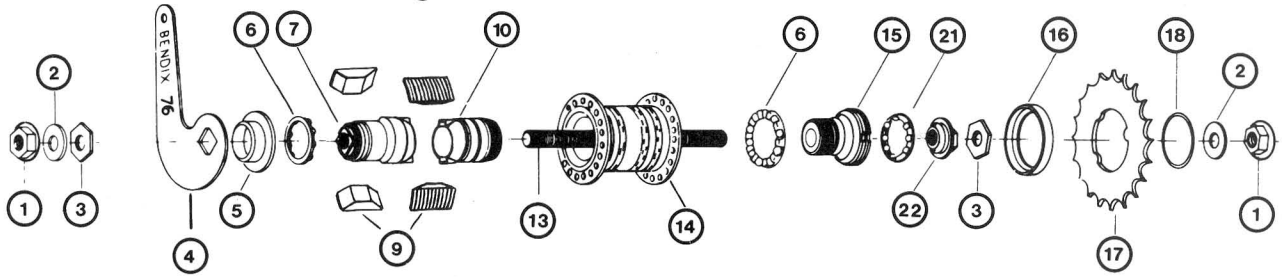

### MODEL 70

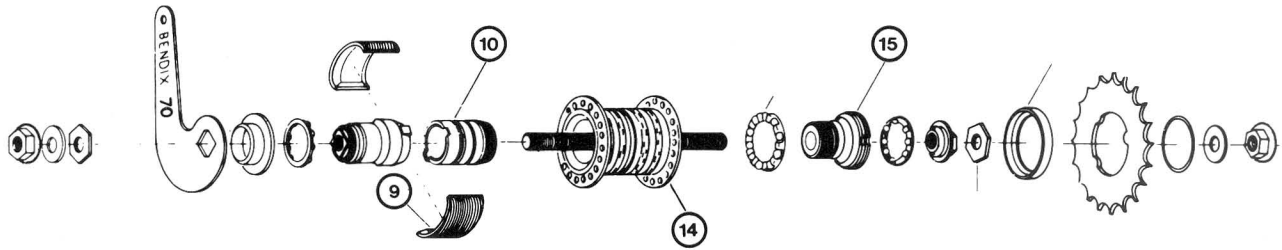

### RB-2 (Red Band 2)

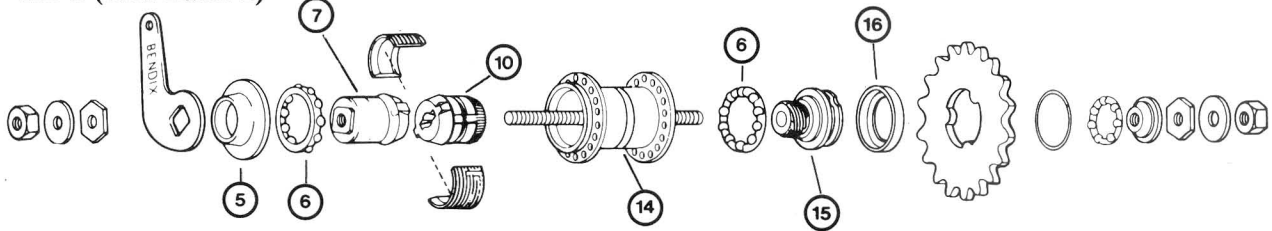

### RB (Red Band)

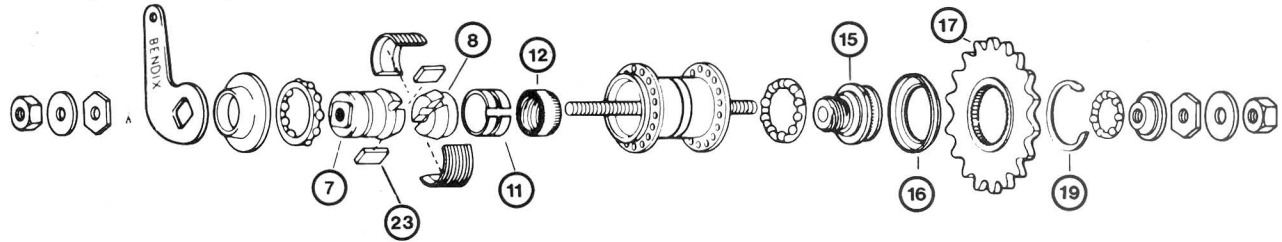

### ORIGINAL

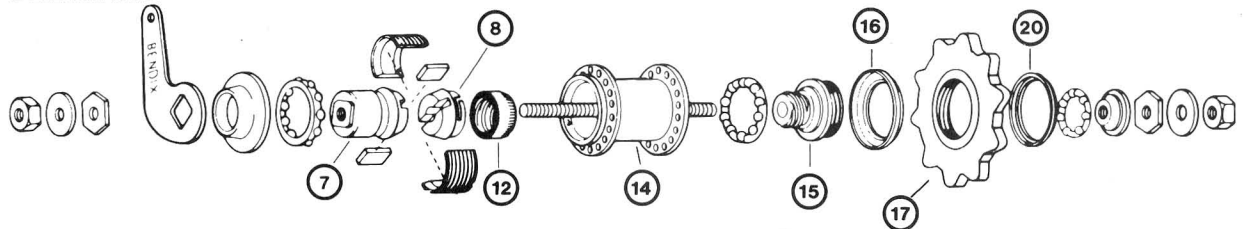

**MODEL 70J (70 Junior)**  
other parts interchangeable  
with Model 70

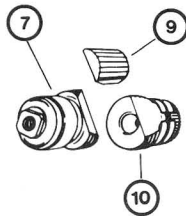

**JUNIOR**  
other parts interchangeable  
with RB-2

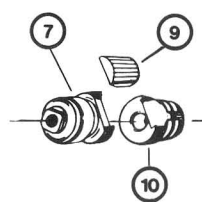

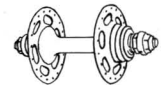

**BENDIX COASTER BRAKE  
PARTS INTERCHANGEABILITY**

Vertical line between numbers indicates parts are not interchangeable.

Parts are interchangeable only if they are on the same line and they do not have a vertical line between them.

		76 short lead models and long lead models	70, 70J 70 Junior	RB-2 Red Band -2, Junior	RB Red Band	Original Bendix
1.	Axle Nut (2 required)	BB-713	BB-13A	BB-13A	BB-13A	BB-13
2.	Axle Washer	BB-14A	BB-14A	BB-14A	BB-14A	BB-14
3.	Locknut	BB-15	BB-15	BB-15	BB-15	BB-15
4.	Brake Arm	BB-710	BB-510	BB-10	BB-10	BB-10
	Junior		BB-610			
	Tandem	BB-710A	BB-510A	BB-10A	BB-10A	BB-10A
5.	Dust Cap, arm side	BB-532	BB-532	BB-32	BB-32	BB-32
6.	Retainer (9-1/4" balls) (2 required)					
	(BB-16 10-1/4" balls)	BB-516	BB-516	BB-16	BB-16	BB-16
7.	Expander, anchor end	BB-533	BB-533	BB-133	BB-59	BB-33
	Junior Expander, anchor end		BB-633	BB-233		
8.	Expander, drive end				BB-56	BB-6
9.	Brake Shoes (BB-722, 4 required)					
	(BB-22, 2 required)	BB-722	BB-22	BB-22	BB-22	BB-22
	Junior Brake Shoes (1 required)		BB-222	BB-222		
10.	Retarder Sub-Assembly, short lead (0.667")	BB-159	BB-159	BB-159		
	long lead, zinc plated (0.900")	BB-759				
	Junior Retarder Sub-Assembly		BB-659	BB-259		
11.	Retarder Spring	BB-112	BB-112	BB-112	BB-112	
12.	Drive Clutch				BB-53	BB-3
13.	Axle 6 3/8" (162 mm) standard length	BB-4	BB-4	BB-4	BB-4	BB-4
	7 3/8" (187 mm) extra length	BB-36	BB-36	BB-36	BB-36	BB-36
	6 3/8" (162 mm) high strength, yellow	BB-4A				
14.	Hub Shell 36 holes 0.080 gauge	BB-781	BB-581	BB-81	BB-81	BB-1
	28 holes 0.080 gauge	BB-782	BB-582	BB-82	BB-82	BB-1B
	24 holes 0.080 gauge	BB-783	BB-583	BB-83	BB-83	BB-1A
	20 holes 0.080 gauge	BB-786	BB-586	BB-86	BB-86	
	40 holes 0.080 gauge			BB-87		
	28 holes 0.105 gauge	BB-787				
	36 holes 0.105 gauge	BB-784	BB-584	BB-84	BB-84	BB-1E
	36 holes 0.120 gauge	BB-785	BB-585	BB-85	BB-85	BB-1C
15.	Drive Screw 6-start multiple thread	BB-502	BB-502	BB-102		
	long lead, zinc plated	BB-702				
	3-start multiple thread				BB-52	BB-2
16.	Dust Cap, sprocket	BB-558	BB-558	BB-158	BB-58	BB-31
17.	Sprocket 14T	BB-143	BB-143	BB-143		BB-43
	15T	BB-142	BB-142	BB-142		
	16T	BB-144	BB-144	BB-144		BB-44
	18T	BB-145	BB-145	BB-145	BB-60	BB-45
	19T	BB-146	BB-146	BB-146	BB-61	BB-46
	20T	BB-147	BB-147	BB-147	BB-62	BB-47
	22T	BB-148	BB-148	BB-148	BB-64	
18.	Snap Ring	BB-155	BB-155	BB-155		
19.	Sprocket Retaining Ring				BB-55	
20.	Sprocket Locknut (left-threaded)					BB-5
21.	Retainer (7-1/4" balls No. 19)	BB-20	BB-20	BB-20	BB-20	BB-20
22.	Adjusting Cone	BB-7	BB-7	BB-7	BB-7	BB-7
23.	Brake Shoe Key				BB-51	BB-51

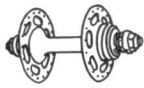

HUBS

BENDIX COASTER BRAKE  
DISASSEMBLY AND ASSEMBLY (cont.)

**1 DISASSEMBLY**

Remove right-hand locknut, adjusting cone, small ball retainer, drive screw and large ball retainer.

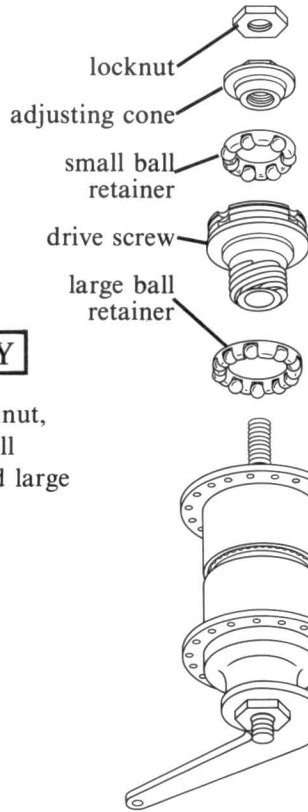

Holding axle in place, turn hub over. Install large ball retainer *flat side up*. Install drive screw and small ball retainer. Thread on adjusting cone and locknut. Adjust bearing.

**ASSEMBLY 3**

Next Step



**2 DISASSEMBLY**

Without inverting assembly, lift hub shell clear of remaining parts. Catch brake shoes as they fall out. Remove retarder assembly.

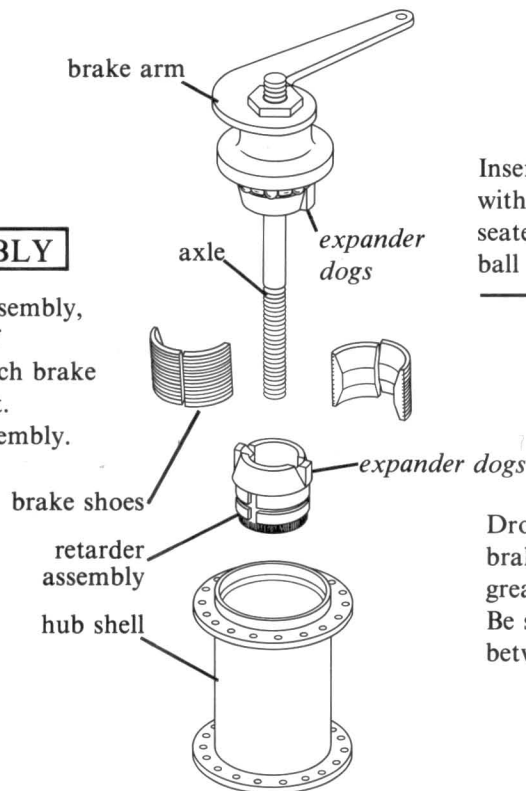

Insert brake-arm/axle assembly into hub with dogs on anchor-end expander seated in gaps between brake shoes and ball retainer seated on hub shell race.

Drop retarder sub-assembly into the brake shell *expander end up*. Stick greased brake shoes in place inside hub. Be sure that expander dogs lie in gaps between brake shoes.

**ASSEMBLY 2**

Next Step  
Next Page



**BENDIX COASTER BRAKE  
DISASSEMBLY AND ASSEMBLY (cont.)**



**3 DISASSEMBLY**

Remove left-hand locknut, brake arm and dust cap. Pop ball retainer off over anchor-end expander. Thread expander off axle if necessary.

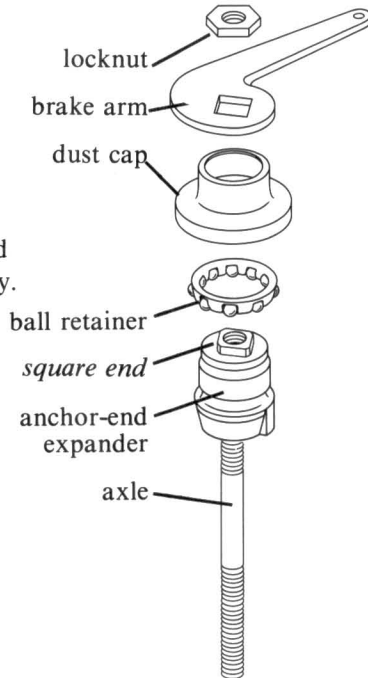

Next Step  
Preceding Page

Install anchor-end expander. Square end should be 1 1/8" (28mm) from end of axle. Place large ball retainer over the expander flat side up. Use dust cap to pop ball retainer into place. Install brake arm and locknut. Tighten locknut by holding it stationary while turning brake arm against it.

**ASSEMBLY 1**

**DISASSEMBLY**

**Retarder**

Pull retarder sub-assembly apart.

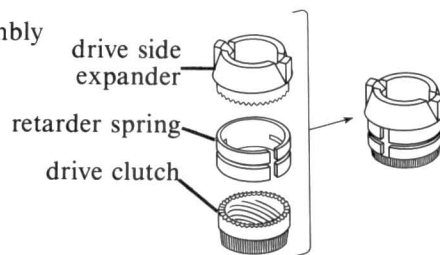

**SUBASSEMBLY**

**Retarder**

Install the retarder spring on the drive side expander. Install the drive clutch in the retarder spring.

**ASSEMBLY**

**CLEANING**

Clean all parts, including outside of hub shell, in a suitable solvent. Be very careful not to introduce dirt or grit after cleaning.

**POINTS TO CHECK**

Numbers in parenthesis refer to parts chart and exploded drawing.

1. Mating threads of drive screw (15) and drive clutch<sup>1</sup> (12) for wear and chipping
2. Conical surface of inside of hub shell and outside of drive clutch<sup>1</sup> (12) for wear and burring
3. Retarder spring (11) for shape and tension

4. Drive clutch<sup>1</sup> (12) and drive side expander (10) for wear or burring of toothed mating surfaces
5. Brake shoes (9) and hub shell mating surfaces for wear or glazing
6. All threaded parts for damaged or stripped threads
7. Dustcaps and bearing retainers for straightness

**LUBRICATION**

Lubricate ball bearings by filling the spaces between balls with grease. Lubricate hub shell and brake shoes liberally with a high-temperature grease. Coat other parts with grease.

<sup>1</sup> For some models, listed only as part of retarder assembly (10).